

WOB-L® PISTON

Compressors and Vacuum Pumps

315 Series

MODELS:

Standard models available.

315CDC45/12

Other models based on availability and minimum purchase.

FEATURES:

- Oil-less design
- Diecast aluminum components
- Steel mounting brackets with vibration isolators
- Stainless steel valves
- Built-in check valve
- PTFE piston ring
- Inlet unloader
- Two stage inlet filter
- Thermally protected motor
- Dust and moisture resistant
- Intermittent duty only
- All wetted aluminum parts treated for corrosion protection from moisture
- All other wetted parts stainless steel

Consult factory for custom applications

Heavy-duty motor (Model 305 - Consult factory)



315CDC



315DDC



315SDC

DIMENSIONS:

Millimeters are in ()

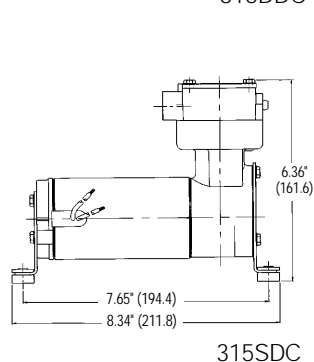
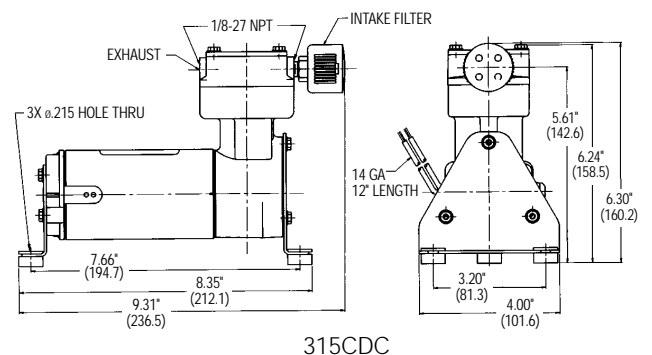
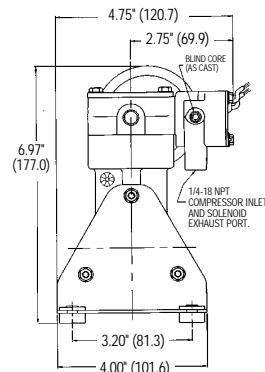
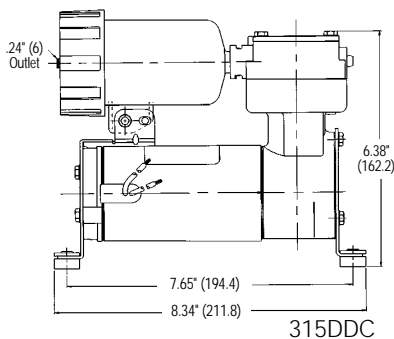

315 SERIES PERFORMANCE DATA:

		STANDARD													
MODEL NUMBER:		315CDC30/12		315CDC40/12		315CDC45/12		315CDC50/12		315CDC56/12		315SDC56/12		315DDC56/12	
HEAD CONFIGURATION:		Pressure/Vacuum		Pressure/Vacuum		Pressure/Vacuum		Pressure/Vacuum		Pressure/Vacuum		Pressure/Vacuum		Pressure/Vacuum	
STROKE:		.300 Inches		.400 Inches		.450 Inches		.500 Inches		.560 Inches		.560 Inches		.560 Inches	
PRESSURE:		Flow @ 12V		Flow @ 12V		Flow @ 12V		Flow @ 12V		Flow @ 12V		Flow @ 12V		Flow @ 12V	
CFM @ PSI	LPM @ bar														
PSI	bar	CFM	LPM	CFM	LPM	CFM	LPM	CFM	LPM	CFM	LPM	CFM	LPM	CFM	LPM
0	0	.86	24.4	1.04	29.4	1.13	32.0	1.18	33.4	.96	27.2	.95	26.9	.90	25.4
20	.5	.66	22.3	.89	28.0	.98	30.5	1.03	31.8	.82	25.7	.78	25.1	.76	24.0
40	1.0	.50	20.2	.74	26.4	.82	29.0	.89	30.3	.71	24.3	.70	23.4	.64	22.6
60	1.5	.38	18.3	.61	24.8	.70	27.4	.76	28.8	.63	23.0	.58	21.8	.56	21.2
80	2.0	.28	16.6	.50	23.3	.60	25.7	.66	27.4	.56	21.8	.50	21.0	.48	19.9
100	3.0	.18	13.6	.41	20.3	.51	22.6	.56	24.6	.49	19.7	.42	19.2	.40	17.7
120	5.0		9.0	.32	15.3	.43	18.0	.47	19.7	.42	16.6	.34	15.0	.32	14.4
140	7.0		4.9		11.4		14.3		15.6	.35	13.7		11.7		11.1
MAX. INTERMITTENT PRESSURE:**		110 PSI	7.6 bar	130 PSI	9.0 bar	130 PSI	9.0 bar	130 PSI	9.0 bar	150 PSI	10.4 bar	120 PSI	8.3 bar	120 PSI	8.3 bar
MAX. DUTY CYCLE: (MINUTES ON/OFF AT 23°C and 100 PSI)		25% (10 on / 30 off)		20% (5 on / 20 off)		17% (4 on / 20 off)		15% (3 on / 20 off)		15% (3 on / 20 off)					
VACUUM:		Flow @ 12V		Flow @ 12V		Flow @ 12V		Flow @ 12V		Flow @ 12V					
CFM @ IN.hg	LPM @ mbar (gauge)														
IN.hg	mbar (gauge)	CFM	LPM	CFM	LPM	CFM	LPM	CFM	LPM	CFM	LPM				
0	0	.86	24.4	1.04	29.4	1.13	32.0	1.18	33.4	.96	27.2				
5	-100	.56	19.3	.71	24.0	.80	26.5	.86	28.1	.74	23.5				
10	-200	.35	14.8	.48	19.0	.54	21.3	.58	22.9	.52	19.8				
15	-400	.16	8.0	.24	11.1	.28	12.6	.29	13.4	.31	12.6				
20	-600		1.6		3.1		4.0		3.7		5.5				
MAX. VACUUM:**		20.0" hg	-677 mbar	20.0" hg	-677 mbar	20.0" hg	-677 mbar	21.0" hg	-712 mbar	22.0" hg	-745 mbar				
MAX. AMBIENT TEMPERATURE:		158°F	70°C	158°F	70°C	158°F	70°C	158°F	70°C	158°F	70°C	158°F	70°C	158°F	70°C
MIN. AMBIENT TEMPERATURE:		-40°F	-40°C	-40°F	-40°C	-40°F	-40°C	-40°F	-40°C	-40°F	-40°C	-40°F	-40°C	-40°F	-40°C
MAX. RESTART PRESSURE:***		110 PSI	7.6 bar	180 PSI	12.4 bar	195 PSI	13.5 bar	210 PSI	14.5 bar	210 PSI	14.5 bar	130 PSI	9.0 bar	130 PSI	9.0 bar
MAX. RESTART VACUUM:		20.0" hg	-677 mbar	20.0" hg	-677 mbar	20.0" hg	-677 mbar	21.0" hg	-711 mbar	22.0" hg	-745 mbar				
MOTOR VOLTAGE:		12V DC		12V DC		12V DC		12V DC		12V DC		12V DC		12V DC	
HORSEPOWER:		1/8		1/6		1/5		1/5		1/5		1/5		1/5	
MOTOR TYPE:		Permanent Magnet		Permanent Magnet		Permanent Magnet		Permanent Magnet		Permanent Magnet		Permanent Magnet		Permanent Magnet	
CURRENT AT RATED LOAD (AMPS):		11.0		16.5		18.5		20.0		20.0		20.0		20.0	
MIN. FULL LOAD SPEED (RPM):		3400		3400		3200		2900		3200		3100		3000	
MIN. VOLTAGE:		8.0		8.0		8.0		9.5		9.0					
THERMAL PROTECTOR:		Yes		Yes		Yes		Yes		Yes		Yes		Yes	
NET WEIGHT:		4.25 lbs.	1.93 Kg	4.25 lbs.	1.93 Kg	4.25 lbs.	1.93 Kg	4.25 lbs.	1.93 Kg	4.25 lbs.	1.93 Kg	5.5 lbs.	2.5 Kg	6.5 lbs.	2.9 Kg

* Duty cycle may vary by application - consult factory.

** Model 315 BDC version available for approximately 26" hg max. vacuum.

*** Solenoid set for pressure relief at 143 ±13 psig (9.9 ±.9 bar).

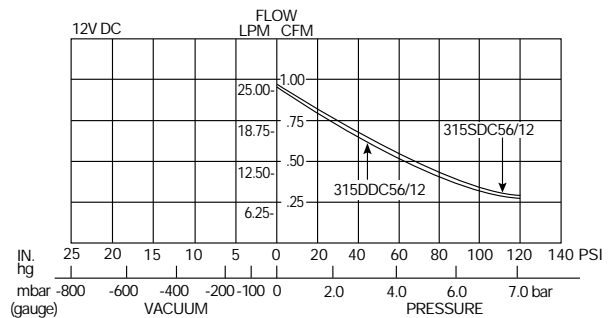
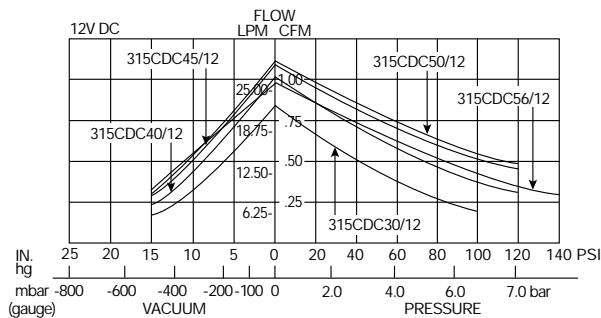

The information presented in this material is based on technical data and test results of nominal units. It is believed to be accurate and reliable and is offered as an aid to help in the selection of Thomas products. It is the responsibility of the user to determine the suitability of the product for his intended use and the user assumes all risk and liability whatsoever in connection therewith. Thomas Industries does not warrant, guarantee or assume any obligation or liability in connection with this information.

